

Installation

S19-310TW8

S19-310TW12

S19-310TW18

Frostproof Combination Drench Shower and Eyewash

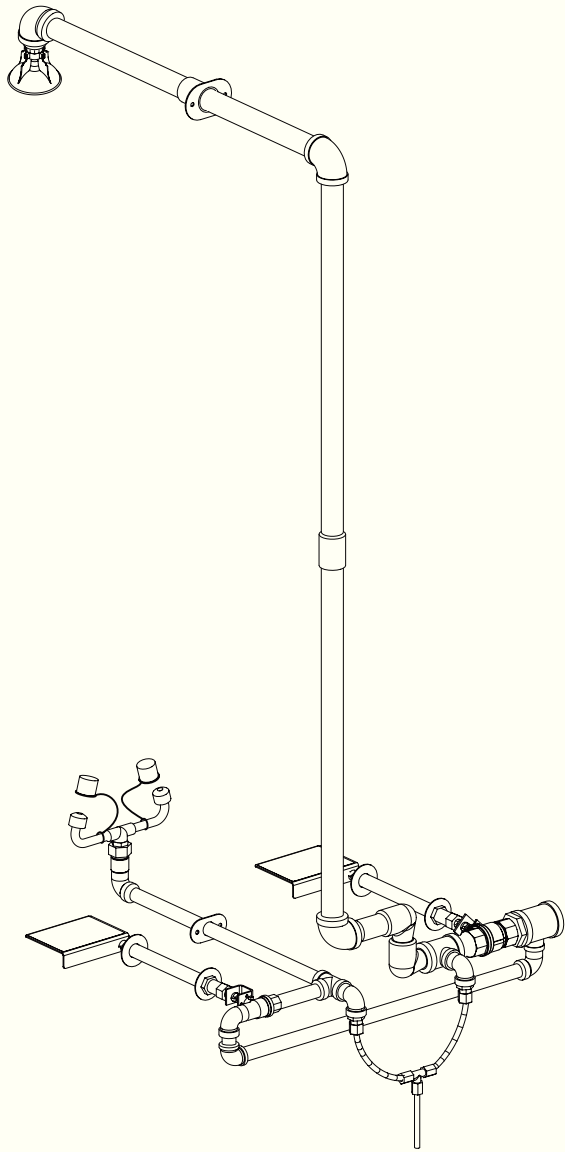

Table of Contents

Pre-Installation Information	2
Dimensions	3
Installation	4
Assembly of Components	5
Parts List	6

[Bradley S19-310TW12 Frost Proof Drench Shower and Eyewash](#)

[Bradley S19-310TW8 Frost Proof Drench Shower and Eyewash](#)

[Bradley S19-310TW18 Frost Proof Drench Shower and Eyewash](#)



S19-310TW8, S19-310TW12, S19-310TW18

IMPORTANT

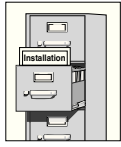

Read this installation manual completely to ensure proper installation, then file it with the owner or maintenance department. Compliance and conformity to drain requirements and other local codes and ordinances is the responsibility of the installer.



Separate parts from packaging and make sure all parts are accounted for before discarding any packaging material. If any parts are missing, do not begin installation until you obtain the missing parts.

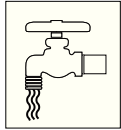

Flush the water supply lines before beginning installation and after installation is complete. Test the unit for leaks and adequate water flow. Main water supply to the eyewash should be "ON" at all times. Provisions shall be made to prevent unauthorized shutoff.

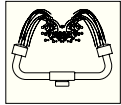

The ANSI Z358.1 standard requires an uninterrupted supply of flushing fluid. Bradley plumbed emergency fixtures require a minimum of 30 PSI (0.21 MPa) flowing pressure. Flushing fluid should be tepid per ANSI Z358.1.

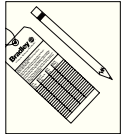

The inspection and testing results of this equipment should be recorded weekly to verify proper operation. This equipment should be inspected annually to ensure compliance with ANSI Z358.1.



Workers who may come in contact with potentially hazardous materials should be trained regarding the placement and proper operation of emergency equipment per ANSI Z358.1.



S19-310TW Dimensions

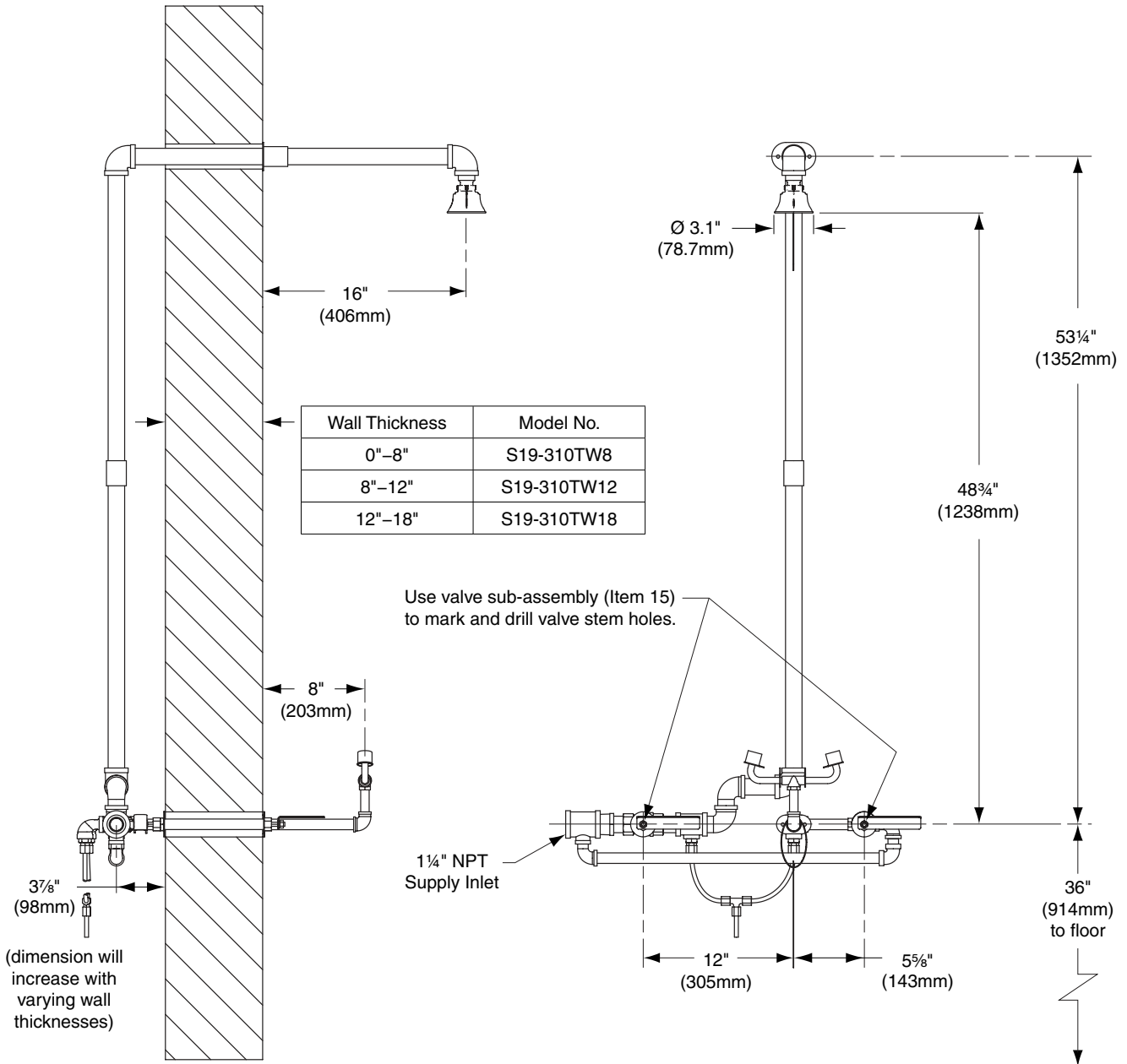

All dimensions assume standard thread engagement. Variations in manufacturing allow for +/- 1/8" (3mm) per threaded joint. To find the tolerance of a dimension, add the number of thread joints in between a dimension and multiply it by 1/8" (3mm).

Installation

Supplies Required:

- Teflon tape and pipe sealant
- Piping to 1¼" NPT water supply inlet
- Adequate supply pipe supports
- Minimum 4" (102mm) drain to accommodate 30 gallons (115 liters) per minute discharge for drench shower waste
- OPTIONAL: Sign-mounting hardware



Local codes may require the installation of a backflow prevention valve to complete proper installation. Compliance with local codes is the responsibility of the installer. Valve must be tested annually to verify that it is functioning properly. Backflow prevention valves are not included with the fixture and may be supplied by the contractor or purchased from Bradley Corporation.

IMPORTANT! Do not rely on Bradley's Combination Unit to support supply piping.

Step 1: Assemble drench shower and eyewash components

1. From the outside of the building, drill a 1" dia. hole in the wall 36" up from the ground floor for the eyewash piping. Use the sub-assembly (Item 15) to measure, mark and drill two 1⅝" dia. holes for the valve operating stems.



This unit has been designed to accommodate varying wall thicknesses. When installing the operating stem support sleeve (Item 27), make sure that a minimum 5/8" of threaded pipe protrudes from the wall.

2. Assemble the two valve stems as shown on page 5 and connect the stems to the assembly through the holes in the wall.
3. Secure the assembly to the wall with adequate supports supplied by installer. Make sure that Item 14 is pitched a minimum of ½" toward the building to allow for proper weep valve drainage.
4. Connect Items 4, 8, 9 and another Item 9 (as shown on page 5) and attach them to Item 15.2.
5. Mark and drill a 1⅜" dia. hole for the shower pipe.
6. Assemble the rest of the unit as shown on page 5.

Step 2: Connect water supply

1. Connect water supply piping to the 1¼" NPT inlet (piping supplied by installer). Provide adequate supports (supplied by installer) for supply pipe using pipe hangers or other means.
2. Run the drain's 5/16" tubing to an adequate drain containment.
3. Hang the safety sign from the unit with the curtain hooks provided (or mount it to the wall using sign-mounting hardware by installer).

Assembly of Components

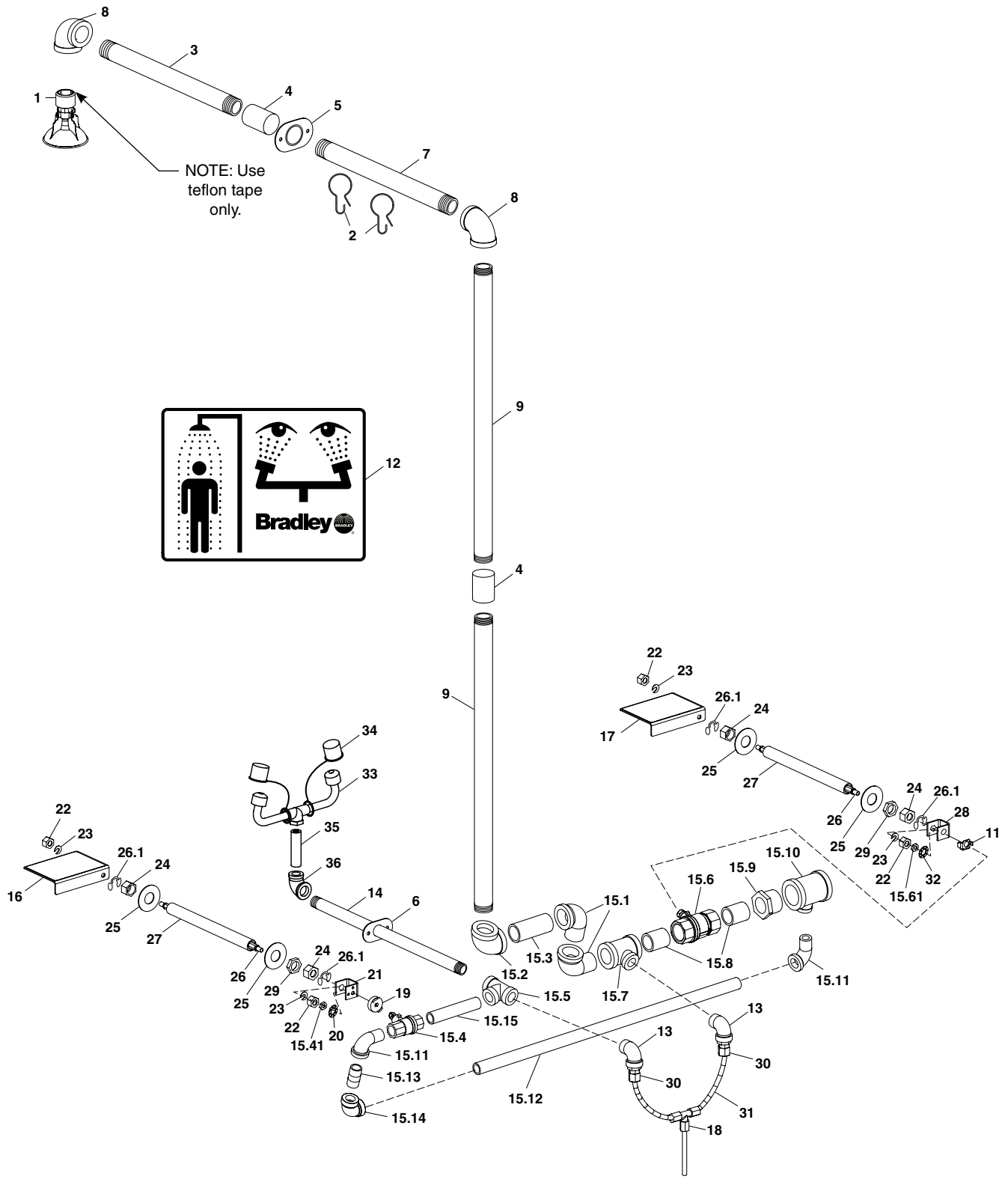



Parts List

Item	Part No.	Qty.	Description
1	S24-188	1	Showerhead, Plastic
2	151-001	2	Hook
3	113-1107	1	Pipe, 1" NPT x 14"
4	169-1027	2	Coupling, 1" NPT
5	150-212	1	Escutcheon, Shower Pipe
6	150-213	1	Escutcheon, Eyewash Pipe
7	113-1108	1	Pipe, 1" NPT x 11½" (S19-10TW8)
	113-1109	1	Pipe, 1" NPT x 15½" (S19-10TW12)
	113-1110	1	Pipe, 1" NPT x 21½" (S19-10TW18)
8	169-847	2	Elbow, 1" NPT
9	113-1112	2	Pipe, 1" NPT x 24"
11	140-720	1	Bracket, 1" Ball Valve Adapter
12	114-052	1	Safety Sign
13	S29-068	2	Weep Valve Assembly
14	113-1116	1	Pipe, ½" NPT x 18¾" (S19-10TW8)
	113-1117	1	Pipe, ½" NPT x 22¾" (S19-10TW12)
	113-1118	1	Pipe, ½" NPT x 28¾" (S19-10TW18)
15	S08-369	1	Valve Sub-Assy, Eyewash/ Shower
15.1	169-723	2	1" Street Elbow 90°
15.2	169-847	1	Elbow, 1" NPT
15.3	113-1113	1	Pipe, 1" x 3"
15.4	S27-282	1	½" Ball Valve with Nut
15.41	110-215	1	Nut (only)
15.5	169-838	1	Tee, ½" NPT
15.6	S27-278	1	1" Ball Valve with Nut
15.61	110-214	1	Nut (only)
15.7	169-840	1	Tee, 1" x 1" x ½"
15.8	113-935	2	Pipe, 1" NPT x 1½"
15.9	269-1721	1	Reduc'g Bushing, 1¼" x 1"
15.10	169-841	1	Tee, 1¼" x ½"

Item	Part No.	Qty.	Description
15.11	169-025	2	90° Street Elbow ½" NPT
15.12	113-1114	1	Pipe, ½" NPT x 23 ¹⁷ / ₃₂ "
15.13	113-1084	1	Pipe, ½" NPT x 1½"
15.14	169-839	1	Elbow ½" NPT
15.15	113-1115	1	Pipe, ½" NPT x 4¼"
16	S08-361	1	Handle, Eyewash
17	S08-360	1	Handle, Shower
18	269-1720	1	Tee, 5/16"Hose, Nylon Union
19	153-372R	1	Adapter, ½" Ball Valve
20	142-002DA	1	Lockwasher, 5/16" Internal Tooth
21	128-151	1	Adapter, ½" Ball Valve Handle
22	161-036	4	Nut, Hex 5/16"-18 Stn. Steel
23	142-002BK	4	Lockwasher, 5/16" Stn. Steel
24	110-191	4	Nut, ½"-14 NPS Connector
25	142-002CB	4	Washer, 7/8" x 2" Stainless Steel
26	S21-067	2	Rod, Operating (S19-310TW8)
	S21-067A	2	Rod, Operating (S19-310TW12)
	S21-067B	2	Rod, Operating (S19-310TW18)
26.1	132-042	4	Clip, Retaining
27	113-006NN	2	Sleeve, Operating Rod (S19-310TW8)
	113-006NR	2	Sleeve, Operating Rod (S19-310TW12)
	113-006NU	2	Sleeve, Operating Rod (S19-310TW18)
28	128-164	1	Adapter, 1" Ball Valve Handle
29	110-115	2	Nut, ½" NSPM
30	269-881	2	ElbowConnector, ¼" NPT, 5/16" Tube
31	R68-600015	4 ft.	Tube, 5/16" Polyethylene
32	142-002DC	1	Lockwasher, 3/8" Internal Tooth
33	S05-091	1	Eyewash Yoke
34	107-371	2	Tethered Dust Cover
35	S21-077	1	Stem
36	169-1069	1	Elbow, ½" x 3/8"